

DEVELOPED BY SUGANDHA APARTMENTS



SOUTH ENCLAVE

AN ADDRESS THAT SPEAKS OF PRESTIGE



Welcome to SouthEnclave

Nestled in the serene hills of Solan, SouthEnclave offers a lifestyle where nature meets elegance. Perched at a prime location with sweeping views of the Shivalik ranges, this exclusive address blends the tranquility of the mountains with the convenience of urban living. Whether it's the crisp mountain air, the panoramic sunrise, or the proximity to schools, markets, and key transit points — SouthEnclave is where elevated living truly begins.



About Developer

Crafted by Experience. Driven by Vision.

SouthEnclave is the brainchild of Mr. Rajeev Chopra, a seasoned name in the real estate industry with over 38 years of trusted experience in delivering quality projects that stand the test of time. Joining him in this endeavour is his son, Er. Rishabh Chopra, a Civil Engineer with an MBA, who brought his technical acumen and modern perspective to the family legacy a decade ago. Together, they combine tradition with innovation to create homes that are not only thoughtfully designed but built to elevate everyday living.



SOLAN KASAULI HILLS

South Enclave Solan is perfectly situated in the heart of the town, offering unmatched accessibility while still being nestled in nature's embrace. Located just off the main road, this drive-in property ensures effortless access for residents and visitors alike, with ample parking space to accommodate modern lifestyle needs.

Key Features

Prime Location

It's an ideal address for those who value both connectivity and tranquility.

1

Modern Amenities

A CBSE School, hospital, SBI Bank, Blinkit office, Restaurants are all within the project.

2

Serene

It maintains a serene and green environment, blending the convenience of urban living with the peace and freshness of the surrounding hills.

3

Spacious Layout

The apartments are the most spacious in town with big airy balconies and the layout is such which guarantees sun all throughout.

4

Commercial Mall

South Enclave features its own commercial mall within the society, offering everyday convenience right at your doorstep. With trusted names like SBI Bank, Domino's Pizza, a salon, Blinkit, and a specialized kidney care hospital, residents enjoy unmatched access to essential services. Additionally, a variety of restaurants and the bustling Mall Road are all within a 2 km radius, making life here both comfortable and connected.



Amenities



Finance

Financial assistance is available



Direct Registry

nulla nisi ad dolore do cupidatat labore eu exercitation fugiat ipsum anim velit ad ipsum commodo voluptate sunt eiusmod labore



Play Areas

There is a big play area for children along with facilities like tennis court, school, coaching for various sports.



Parking

There is covered parking available and all apartment blocks are motorable.



Amenities

Community Areas

Gazebos and sitout spaces to sit around the society. Strong community of people from good esocial background.



Security Features

Gated society with a 24X7 guard



Convenience

Society hosts within it a commercial mall, eateries, hospital, school and a bank. Water and electricity connections are direct.



Eco-Friendly Living

The construction follows all legal binding and rules and the landscaping ensures a lot of greenery in and around the apartments.





Floor Plan

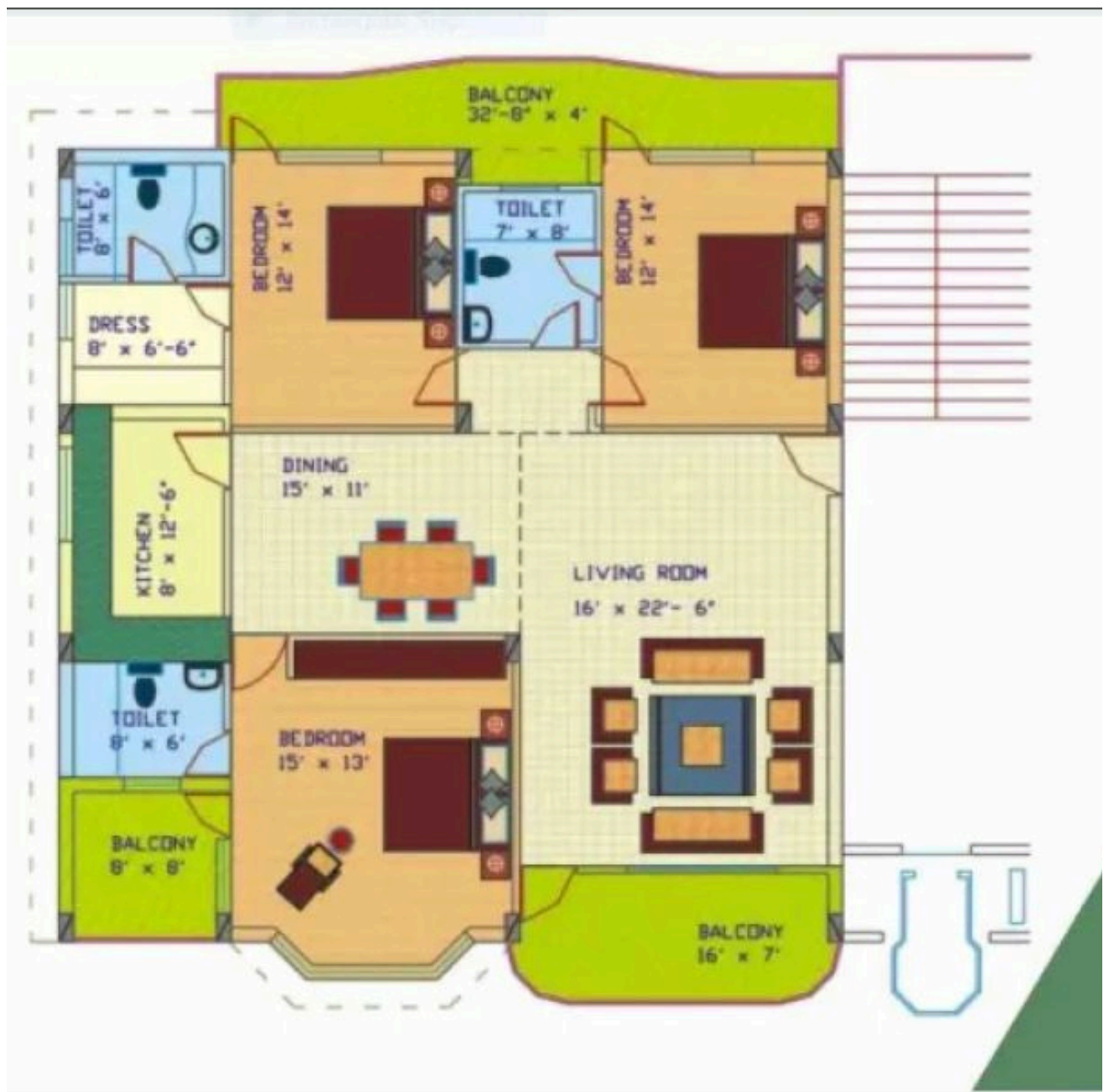



Specifications

1

Spacious Floor
Plans

2

High-Quality
Finishes

3

Modern Kitchen,
Bedrooms and
Bathrooms



4

Well Lit Rooms

5

Independent
Water and
electricity
connection

6

Within MC
limits

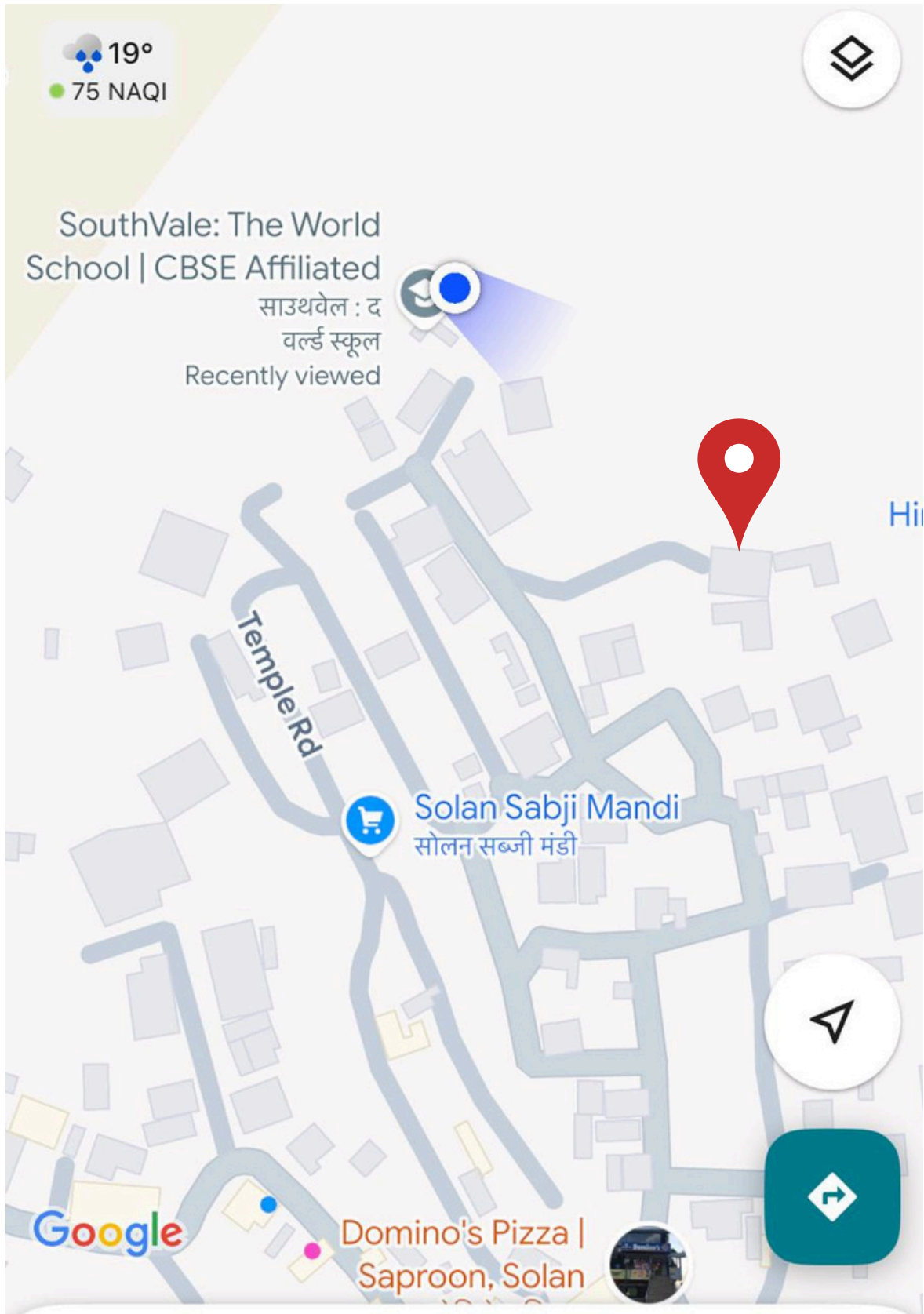

Location Map



Location Benefits

1

Proximity to
Amenities

2

Excellent
Transportation Links

3

Top-Rated CBSE
School

4

Green Spaces and
Recreation

5

Safe and Secure
Neighborhood

6

High Growth
Potential

Contact Information

SOUTH ENCLAVE

Call on:

98160 22888

98160 06888

62300 81888

Site Address:

**ByePass Road, South Enclave, Sugandha
Apartments, Solan**